

ALCOSMART®

ALCOHOL TEST

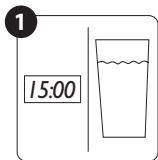

1. Wait 15 minutes after last alcoholic beverage, or drink 10 oz. of water before use.

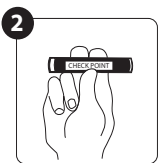

2. Do not use if inner glass capsule is broken or if crystals are not yellow. Squeeze middle of test to break inner glass capsule. Squeeze only once. Do not bend or twist. Rotate to distribute crystals in viewing area.

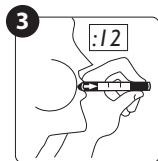

3. Blow hard into end of test for 12 seconds. Do not inhale through test.

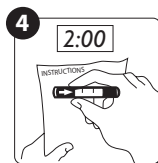

4. Read results in two minutes. The .02 tester will change to a greenish color to indicate the presence of alcohol at the .02 level or higher. The .04, .05, and .08 tester will change to a green color when alcohol is present below the cut-off level, and a blue color at or above the cut-off level. The color change is more readily seen when comparing against an un-used test.

CAUTION

Do not inhale contents. Do not ingest. If ingested, induce vomiting and contact your physician. Keep out of the reach of children.

Do not immerse in liquid.

Any decision based on the results of this test is the sole responsibility of the User.

Do not drink and drive.

ALCOSMART[®] ALCOHOL TEST

Intended Use

The ALCOSMART alcohol test is a disposable alcohol test designed for one-time use. The ALCOSMART is intended for use as an alcohol screening device for use in workplace alcohol testing programs, in corrections and law enforcement programs, and in other non-medical alcohol testing programs. The ALCOSMART provides a reliable indication of alcohol use when the instructions for use are carefully followed.

Principle of Operation

The ALCOSMART uses a well-known chemical reaction to indicate the presence of alcohol. When reagent-treated silica gel is exposed to breath alcohol at a .02% concentration or higher, the alcohol in the breath creates a chemical reaction that changes the yellow color to a green color, and then to a blue color at higher alcohol concentrations.

WARNING:

- Keep out of the reach of children.
Do not immerse in liquid.
- Do not inhale contents. Do not ingest. If ingested, induce vomiting and contact your physician.
- This product should be used only as a screening device and is only an indication of the possible presence of alcohol in a person's system. This device is not intended to legally determine the presence of alcohol or the concentration of alcohol in a person.
- Do not use if glass capsule is broken or if crystals are not yellow.

The ALCOSMART alcohol test is guaranteed to be free from manufacturer's defects. *This warranty is expressly made in lieu of any and all other warranties expressed or implied including the warranties of merchantability and fitness for a particular purpose or use. There are no warranties expressed beyond the description of the product contained on this package. The warrantor expressly disclaims liability for incidental, special, or consequential damages of any nature.*